

SITE PLAN OF PLOT NO- 71/ AT A - BLOCK GOVINDPURAM GZ

PLOT AREA NO OF 71/8 TO 71/10 = 127.00 SQ.MT.

PLOT AREA NO OF 71/6 = 290.35 SQ.MT.

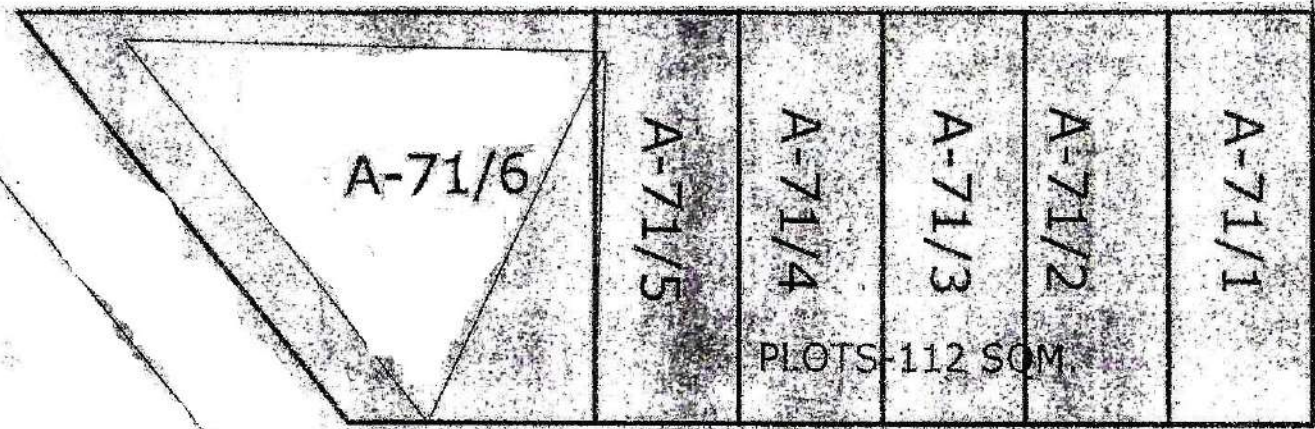

LOTS-112 SOM

9.0M WIDE ROAD

9.0M WIDE ROAD

PREPARED BY

COMPARED BY

J.E.

A.T.

E.E.

T.P.

SITE PLAN OF PLOT NO. CP- AT C-BLOCK GOVINDPURAM.

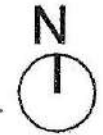
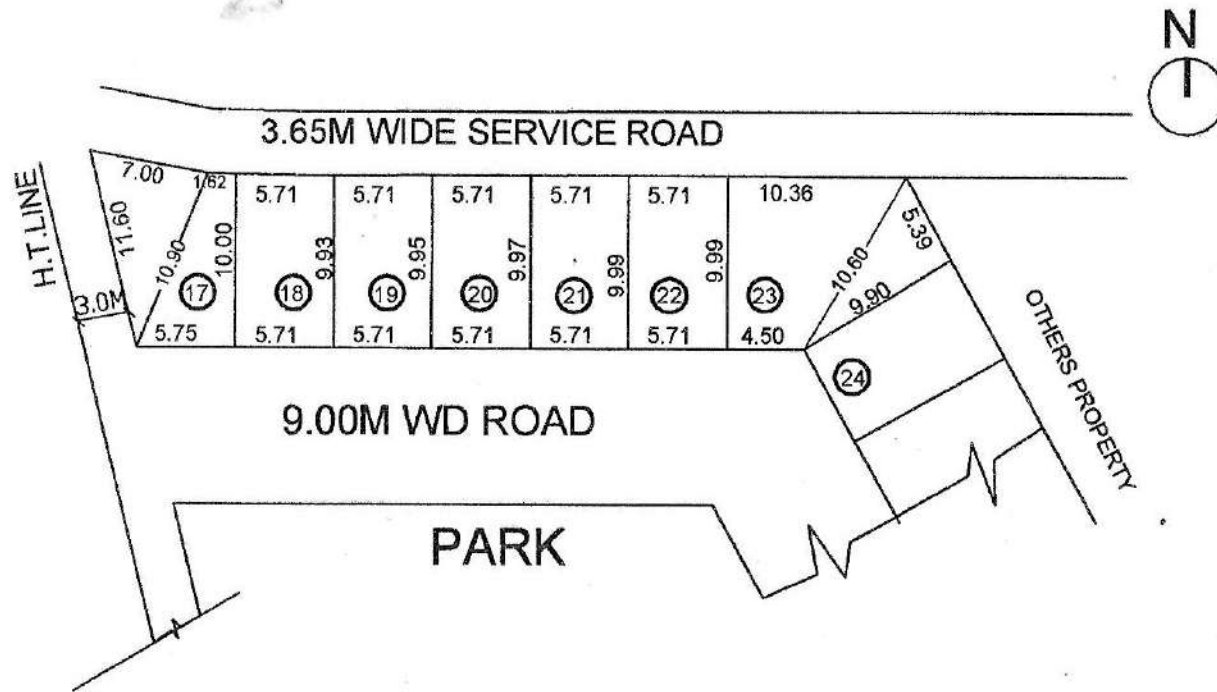

AREA CHART	
PLOT NO.	AREA
17	74.10 SQM
18	56.91 SQM
19	56.76 SQM
20	56.91 SQM
21	57.00 SQM
22	57.15 SQM
23	101.02 SQM

[Signature]
19-11-15
PREPARED BY.

[Signature]
11/12/15
COMPARED BY.

[Signature]
9/12/15
J.E.

[Signature]
9/12/15
A.E.

[Signature]
EX.EN

[Signature]
T.P

PROPOSED SITE PLAN OF PLOT NO. - 45/3 TO 45/10, BLOCK-C, BRIJ VIHAR SECTOR-8, T.H.A., GHAZIABAD

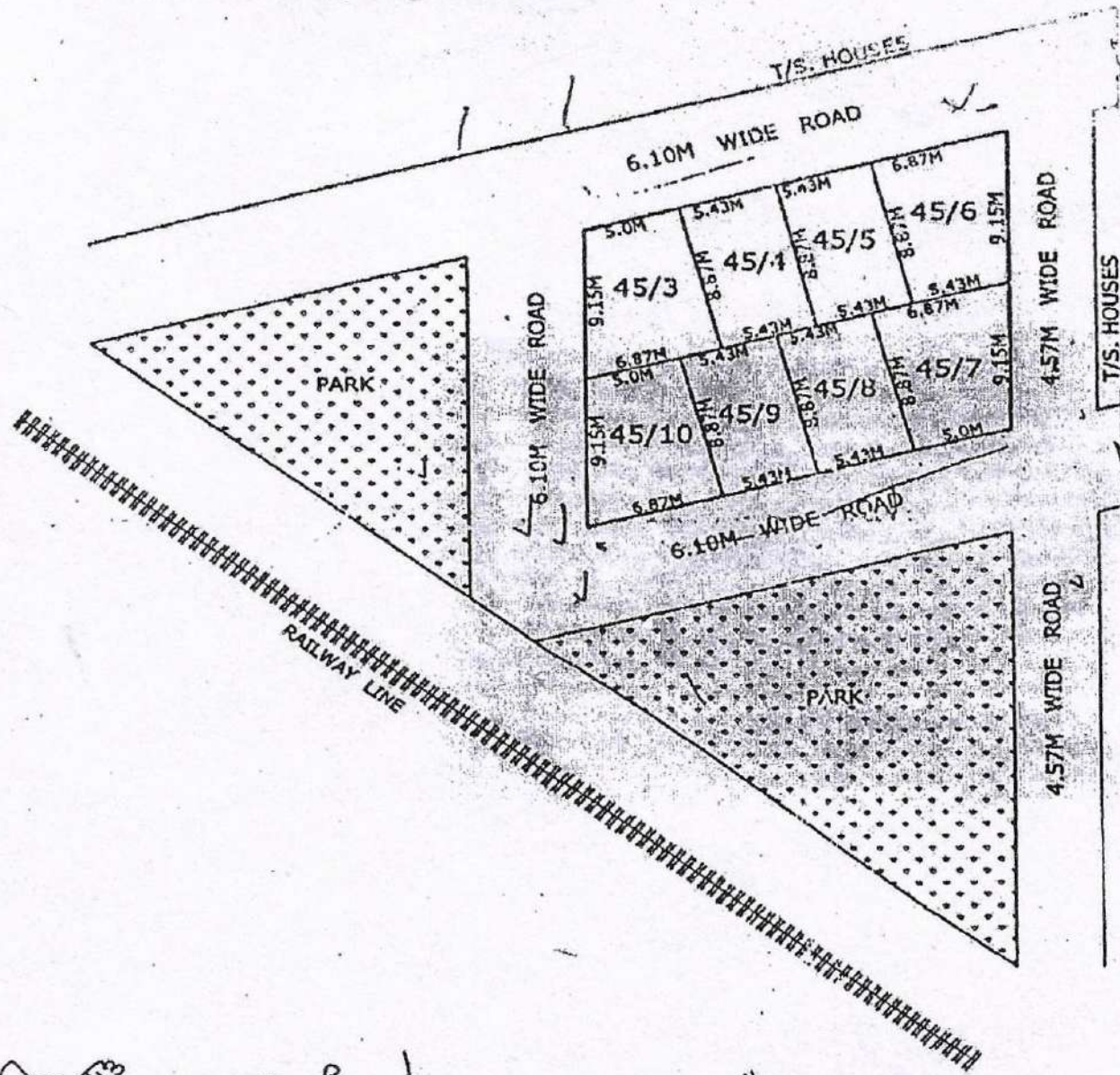

AREA CHART

P.NO. 45/3	=	55.85	SQM.
P.NO. 45/4	=	48.19	SQM.
P.NO. 45/5	=	48.19	SQM.
P.NO. 45/6	=	55.85	SQM.
P.NO. 45/7	=	56.20	SQM.
P.NO. 45/8	=	48.19	SQM.
P.NO. 45/9	=	48.19	SQM.
P.NO. 45/10	=	55.55	SQM.

[Signature]
12/03/13
D/MAN

[Signature]
J.E

[Signature]
A.E

[Signature]
E.E

[Signature]
27/3/13
TOWN PLANNER

[Signature]
25/3/13
C.A.T.P

CEGV

[Signature]

REVISED PART LAYOUT PLAN OF FILLING STATIONS (FS-1 & FS-2) COMMERCIAL PLOT AT KOYAL ENCLAVE SCHEME, LONI, GHAZIABAD

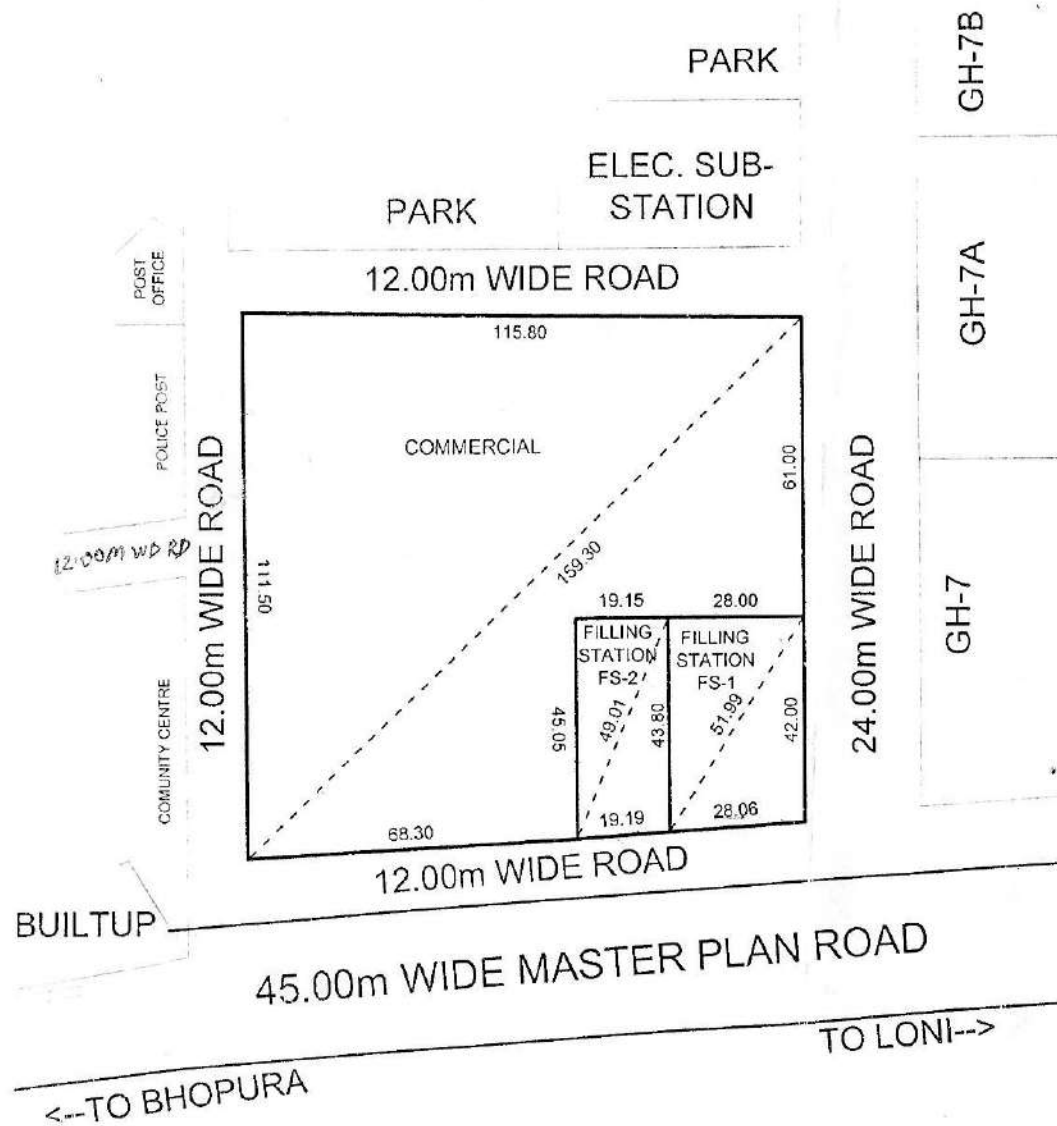

AREA SCHEDULE

FILLING STATION (FS-1)	= 1201.86 Sqmt.
FILLING STATION (FS-2)	= 850.90 Sqmt.
COMMERCIAL	= 10343.29 Sqmt.



AMIN
J.E. *[Signature]*
A.E.
Ex. E.
OSD. (L.A.)
T. P. (R)
T. P. (K)
C.A.T.P. SECRETARY *[Signature]*
VICE CHAIRMAN *[Signature]*

REVISED PART LAYOUT PLAN OF COMMERCIAL LAND IN INDRAPRASTH YOZNA, POCKET - H, LONI, GZB.

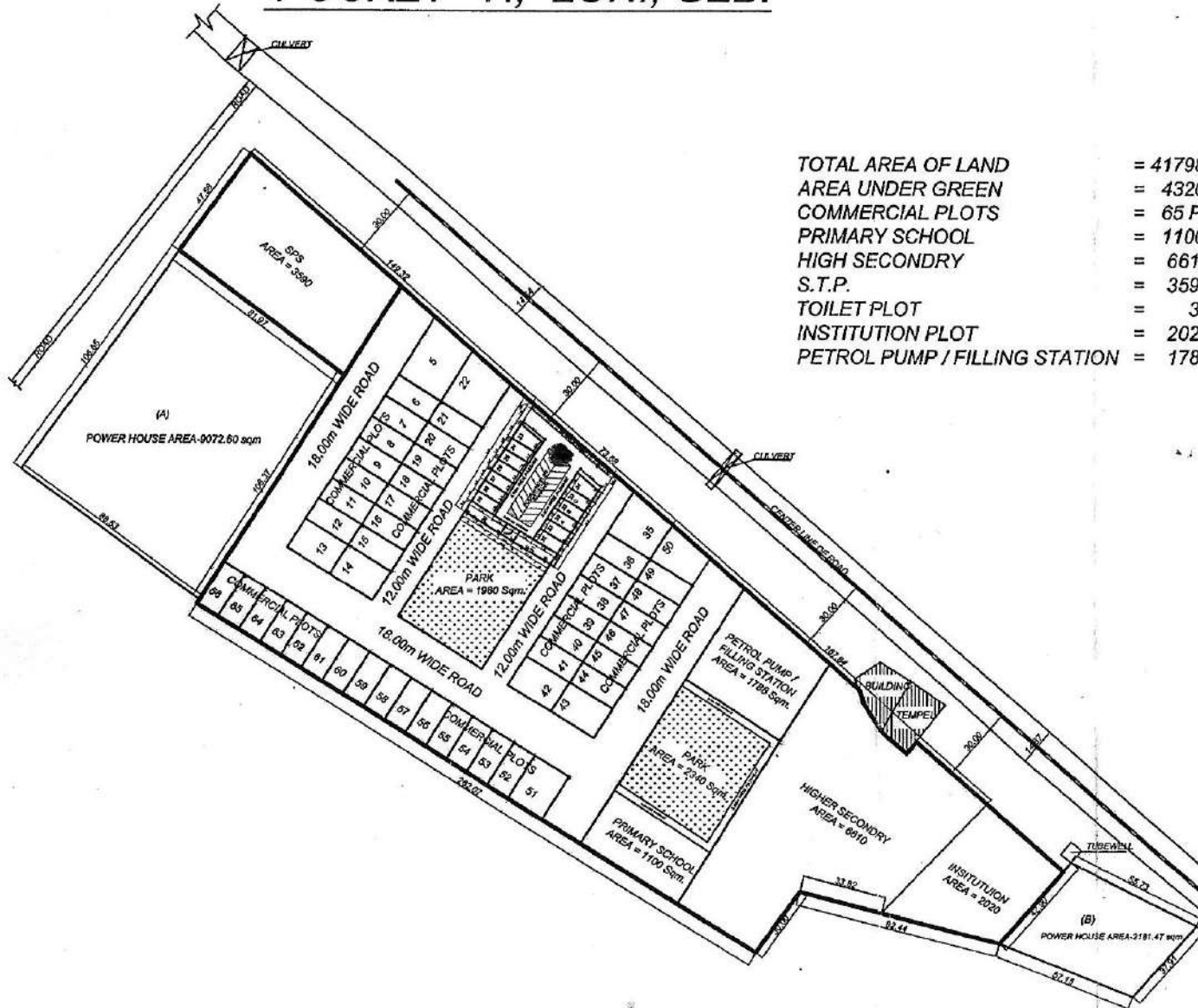
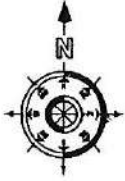

TOTAL AREA OF LAND	= 41798.00 Sqm.
AREA UNDER GREEN	= 4320.00 Sqm.
COMMERCIAL PLOTS	= 65 PLOTS
PRIMARY SCHOOL	= 1100.00 Sqm.
HIGH SECONDRY	= 6610.00 Sqm.
S.T.P.	= 3590.00 Sqm.
TOILET PLOT	= 30.00 Sqm.
INSTITUTION PLOT	= 2020.00 Sqm.
PETROL PUMP / FILLING STATION	= 1788.00 Sqm.

AREA SCHEDULE (COMM. PLOTS)

PLOT Nos.	AREA (IN Sqm.)
5	510.00
6 To 12	195.00
13 & 14	270.00
15 To 21	195.00
22	445.00
23	64.05
24 To 29	55.00
30 & 31	85.00
32 & 33	55.00
33A, 33B & 33C	55.00
34	65.20
35	380.00
36 To 41	195.00
42 & 43	270.00
44 To 49	195.00
50	292.00
51	314.00
52 To 66	195.00

SITE PLAN OF PLOT NO-NP- IN 1 BLOCK GOVINDPURAM GMP. GZD

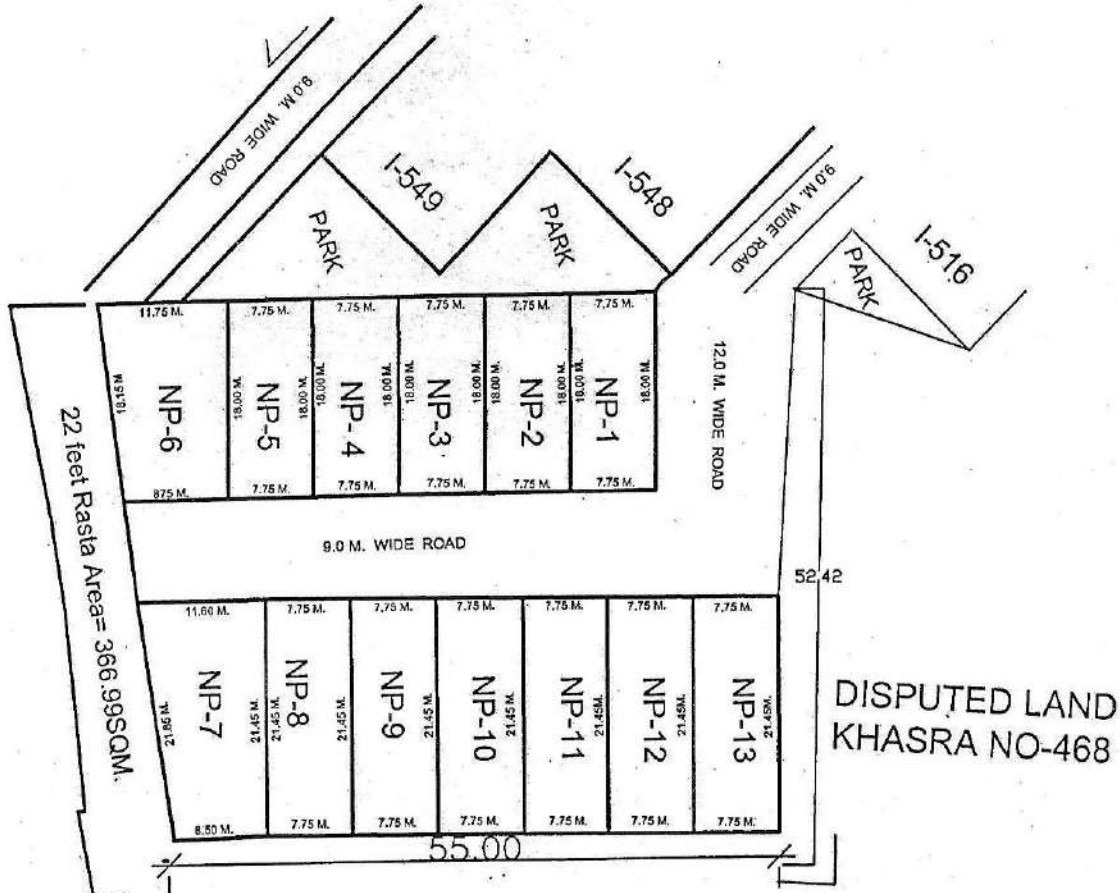

PLOT NO-	AREA
NP- 1	139.50SQM.
NP- 2	139.50SQM.
NP- 3	139.50SQM.
NP- 4	139.50SQM.
NP- 5	139.50SQM.
NP- 6	184.50 SQM.
NP- 7	215.57 SQM.
NP- 8	166.23 SQM.
NP- 9	166.23 SQM.
NP- 10	166.23 SQM.
NP- 11	166.23 SQM.
NP- 12	166.23 SQM.
NP- 13	166.23 SQM.

PREPARED BY

 21/01/19

COMPARED BY

 21/01/19

J.E

 21/01/19

A.E



EE-3

 21/01/19

T.P

 21/01/19

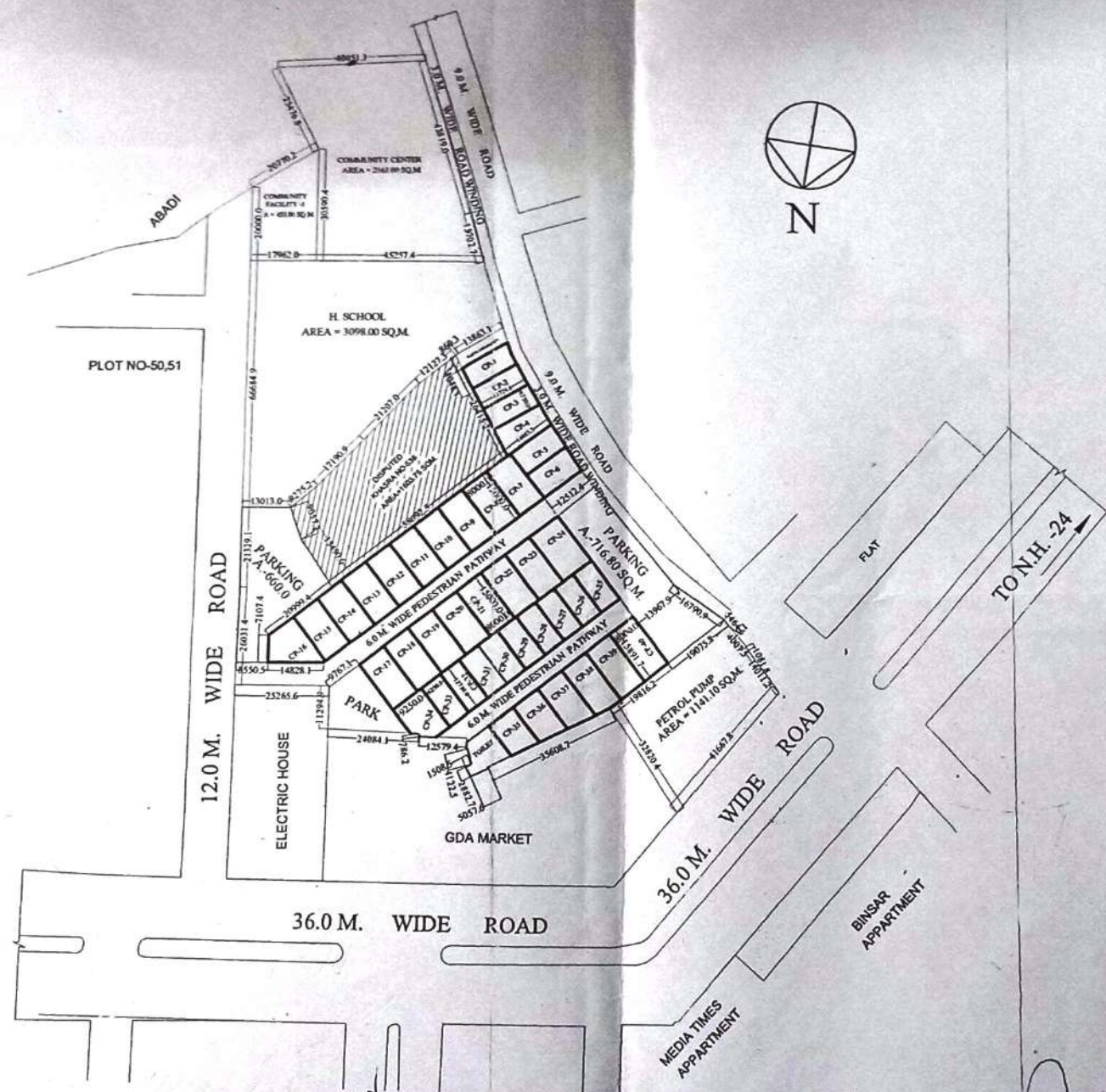
REV. PART LAYOUT PLAN OF COMMERCIAL PLOTS (VEHICLE FREE) AT NYAY KHAND-1 INDIRAPURAM GZB.



AREA-CHART

CP-1	= 87.02 Sqmt.
CP-2	= 88.07 Sqmt.
CP-3	= 88.71 Sqmt.
CP-4	= 101.05 Sqmt.
CP-5	= 94.87 Sqmt.
CP-6	= 99.13 Sqmt.
CP-7 to CP-15	= 120.00 Sqmt.
CP-16	= 116.24 Sqmt.
CP-17 to CP-23	= 120.00 Sqmt.
CP-24	= 142.25 Sqmt.
CP-25 to CP-33	= 79.68 Sqmt.
CP-34	= 107.11 Sqmt.
CP-35	= 85.84 Sqmt.
CP-36	= 99.21 Sqmt.
CP-37	= 112.59 Sqmt.
CP-38	= 124.48 Sqmt.
CP-39	= 126.61 Sqmt.
CP-40	= 126.69 Sqmt.
PARKING	= 1376.80 Sqmt.

D/MAN J.E. A.E. E.E. T.P.(R) T.P.(G) SECRETARY VICE CHAIRMAN

24/11/2020

PART LAYOUT PLAN OF SHOPS PLOT , HOTEL, COMMERCIAL & NURSING HOME PLOT ON COMMERCIAL (COM-2) PLOT & COMMERCIAL/RESIDENTIAL (C/G.H.-1) PLOT IN POCKET C , MADHUBAN BAPUDHAM YOJNA GHAZIABAD

TOATAL AREA OF LAND	= 60938.57 SQ.M.	SHOPS PLOT - 10.00M. X 28.15M.	- 281.50 SQ.M.	- 10 (C/S.P.-06 TO C/S.P.-15)
AREA UNDER SHOPS PLOT	= 21632.30 SQ.M.	SHOPS PLOT - 10.00M. X 20.00M.	- 200.00 SQ.M.	- 38 (C/S.P.-50 TO C/S.P.-64 ,C/S.P.-89 TO C/S.P.- 111)
AREA UNDER HOTEL	= 1788.72 SQ.M.	SHOPS PLOT - 09.00M. X 18.00M.	- 162.00 SQ.M.	- 39 (C/S.P.-01 TO C/S.P.-05 ,C/S.P.-16 TO C/S.P.- 49)
AREA UNDER NURSING HOME	= 1308.58 SQ.M.	SHOPS PLOT - 08.00M. X 12.50M.	- 100.00 SQ.M.	- 47 (C/S.P.-65 TO C/S.P.-88 ,C/S.P.- 112 TO C/S.P.-134)
AREA UNDER COMMERCIAL	= 1154.00 SQ.M.	TOTAL NOS. OF SHOPS PLOT	- 134	
AREA UNDER MULTILEVEL P.	= 5468.95 SQ.M.			
AREA UNDER TOILET /D.W.	= 322.60 SQ.M.			
AREA UNDER GREEN/CENTRAL PLAZA	= 7877.60 SQ.M.			
AREA UNDER CAR PARKING	= 2824.32 SQ.M.			
AREA UNDER PAVED PATHWAY	= 18561.50 SQ.M.			
TOTAL NOS. OF CAR IN CAR PARKING	- 185			

SHOPS PLOT
 F.A.R = 3 - G.F.L.,F.F. & S.F. (AS PER CONTROL DRG.)
 (BASEMENT AREA IS FREE FORM FAR.)
 GROUND COVERAGE = 100 %



REVISED PART LAYOUT PLAN OF C.CENTER, H. SCHOOL, COMM. & PETROL PUMP AT NYAY KHAND-1 INDIRAPURAM GHAZIABAD.

NOTE - A, B, C, D AREA IS UNDER G.D.A. OWNERSHIP

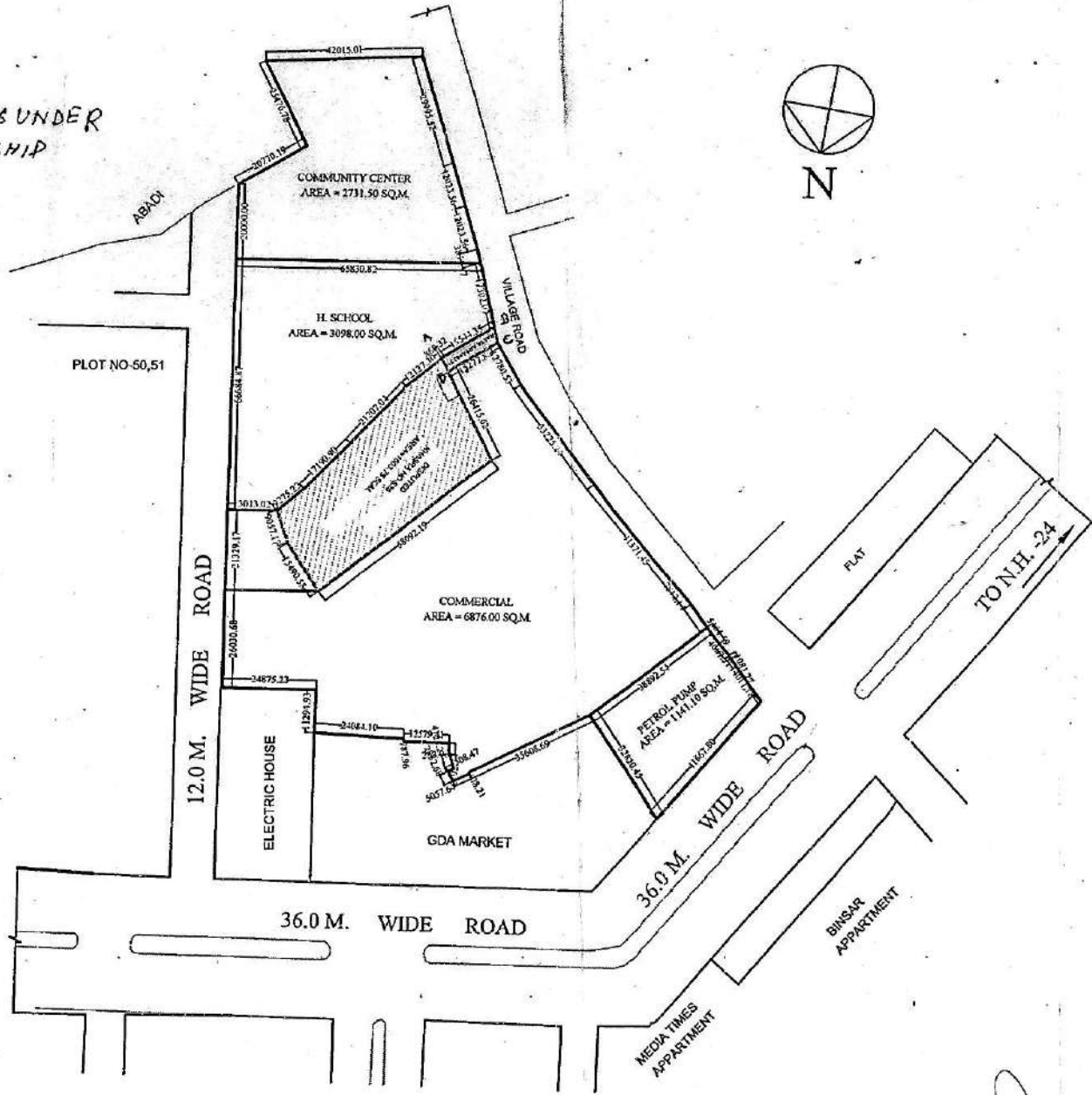

[Signature]
DMAN

[Signature]
AMIN

[Signature]
A.T.P.

[Signature]
A.E.

[Signature]
S.E.

26-3-18
E.E.

TEH.-I.A.

[Signature]
T.P.

[Signature]
C.A.T.P.

[Signature]
SECRATRY

[Signature]
VICE CHAIRMAN

REVISED LAYOUT PLAN OF INDUSTRIAL POCKET MADHUBAN-BAPUDHAM SCHEME AT NH-58 GZB.

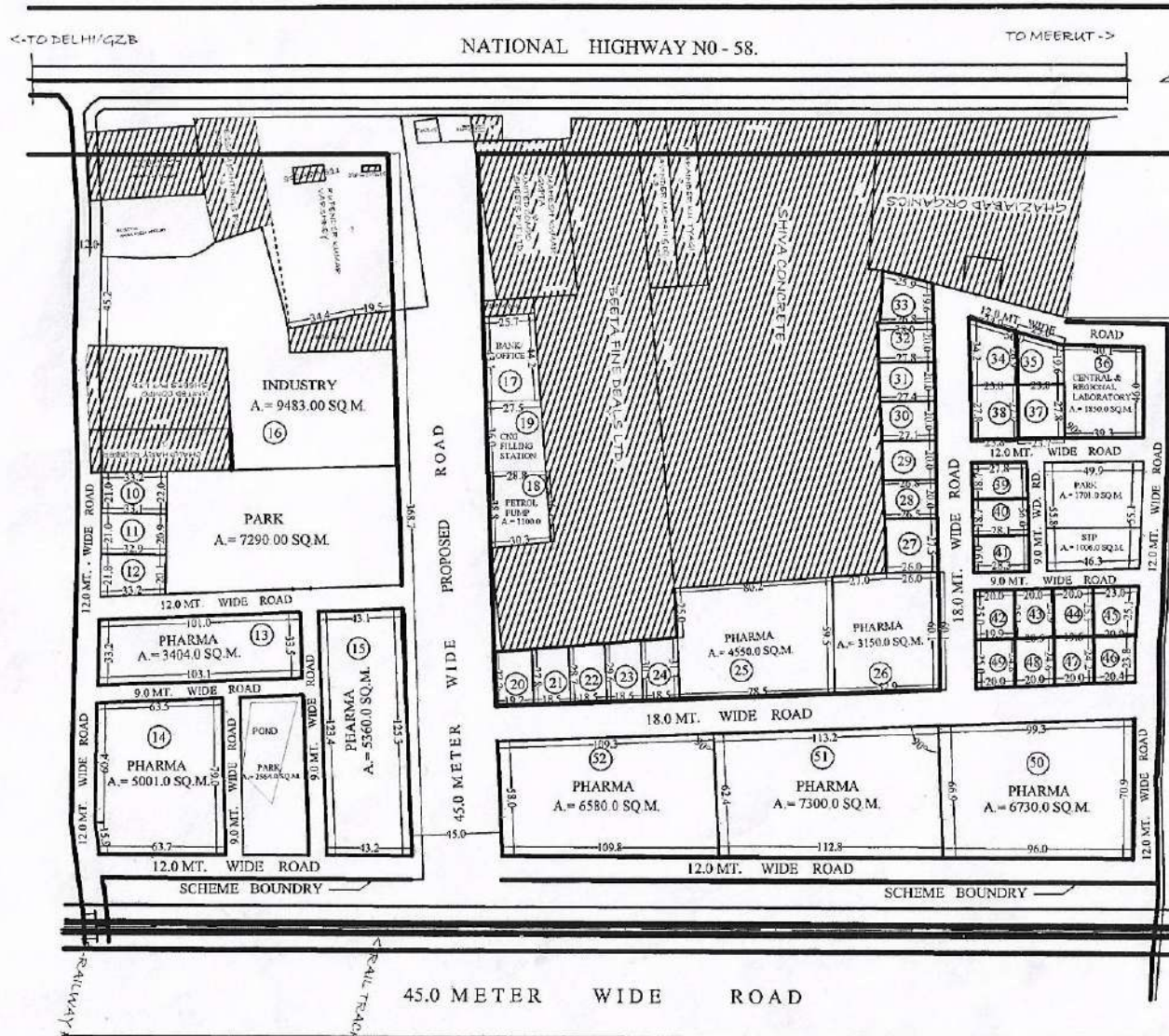

AREA DETAIL
AREA OF SCHEME = 114476.0 SQ.M.
 (EXCLUDING 45.0 MT. WIDE PROPOSED ROAD)
 AREA UNDER PLOT = 73925.0 SQ.M.
 AREA UNDER S.T.P. = 1006.0 SQ.M.
 AREA UNDER PARK = 11555.0 SQ.M.
 AREA UNDER ROAD = 27990.0 SQ.M.

PLOT NO.	USE	AREA (APROX) Sq.M.
10 to 12	INDUSTRIAL	692.00 (EACH)
13	PHARMA	3404.00
14	PHARMA	5001.00
15	PHARMA	5360.00
16	INDUSTRY	9483.00
17	BANK/OFF.	1158.00
19	C.N.G. FILL ST.	1012.00
18	PETROL PUMP	1100.00
20 to 24	INDUSTRIAL	540.00 (EACH)
25	PHARMA	4550.00
26	PHARMA	3150.00
27	INDUSTRIAL	525.00
28	INDUSTRIAL	533.00
29	INDUSTRIAL	539.00
30	INDUSTRIAL	545.00
31	INDUSTRIAL	552.00
32	INDUSTRIAL	558.00
33	INDUSTRIAL	527.00
34	INDUSTRIAL	743.90
35	INDUSTRIAL	567.70
36	CENT REG. LAB.	1850.00
37	INDUSTRIAL	661.41
38	INDUSTRIAL	662.83
39	INDUSTRIAL	519.86
40	INDUSTRIAL	525.47
41	INDUSTRIAL	535.80
42	INDUSTRIAL	498.78
43	INDUSTRIAL	500.00
44	INDUSTRIAL	500.00
45	INDUSTRIAL	550.94
46	INDUSTRIAL	495.60
47	INDUSTRIAL	483.12
48	INDUSTRIAL	506.35
49	INDUSTRIAL	496.75
50	PHARMA	6730.00
51	PHARMA	7300.00
52	PHARMA	6580.00

pocket-b

SITE PLAN OF PLOT FOR BANK, ART GALLERY, HOTEL & FILLING STATION AT KARPOORI PURAM SCHEME.



- AREA OF ART GALLERY = 540 SQM
- AREA OF BANK = 580.00 SQM
- AREA OF HOTEL = 1007.00 SQM
- AREA OF FILLING STATION = 533.00 SQM

PREPARED BY. *[Signature]* AMIN MEASURED BY. *[Signature]* J.E. A.E. E.E. *[Signature]* T.E.H.(L.A.) T.P. *[Signature]* C.A.T.P. SECY. *[Signature]*

REVISIED PART LAYOUT PLAN OF COMMERCIAL PLOT C-1/1 TO C-1/16 & GROUP HOUSING PLOT GH-4 AT, KOYAL ENCLAVE SCHEME, LONI, G.D.A. GHAZIABAD



COMMERCIAL SET BACK
 BELOW 200.00 Sqmt. FRONT - 1.00 Sqmt. REAR - 1.00 Sqmt.
 ABOVE 200.00 Sqmt. FRONT - 1.50 Sqmt. REAR - 1.00 Sqmt. SIDE - 1.00 Sqmt.



AREA SCHEDULE	
PLOT No.	AREA (IN Sqmt.)
C-1/1 ✓	469.78
C-1/2 ✓	457.36
C-1/3 ✓	485.00
C-1/4 ✓	570.61
C-1/5 ✓	153.40
C-1/6 to C-1/11 ✓	112.50
C-1/12 ✓	120.00
C-1/13 ✓	458.71
C-1/14 & C-1/15 ✓	413.32
C-1/16	456.29
GH-04	12867.54

COMMERCIAL PLOTS
 PERMITTED COVERAGE - 25%
 AS PER SECTION 117

 26/08/2020
 Dhanraj
 JUNIOR ENGINEER
 Formation of only
 27/8
 ASSISTANT ENGINEER

 SUPERINTENDENT ENGINEER

 TOWN PLANNER (I)

 TOWN PLANNER (II)

 SECRETARY

 VICE CHAIRMAN







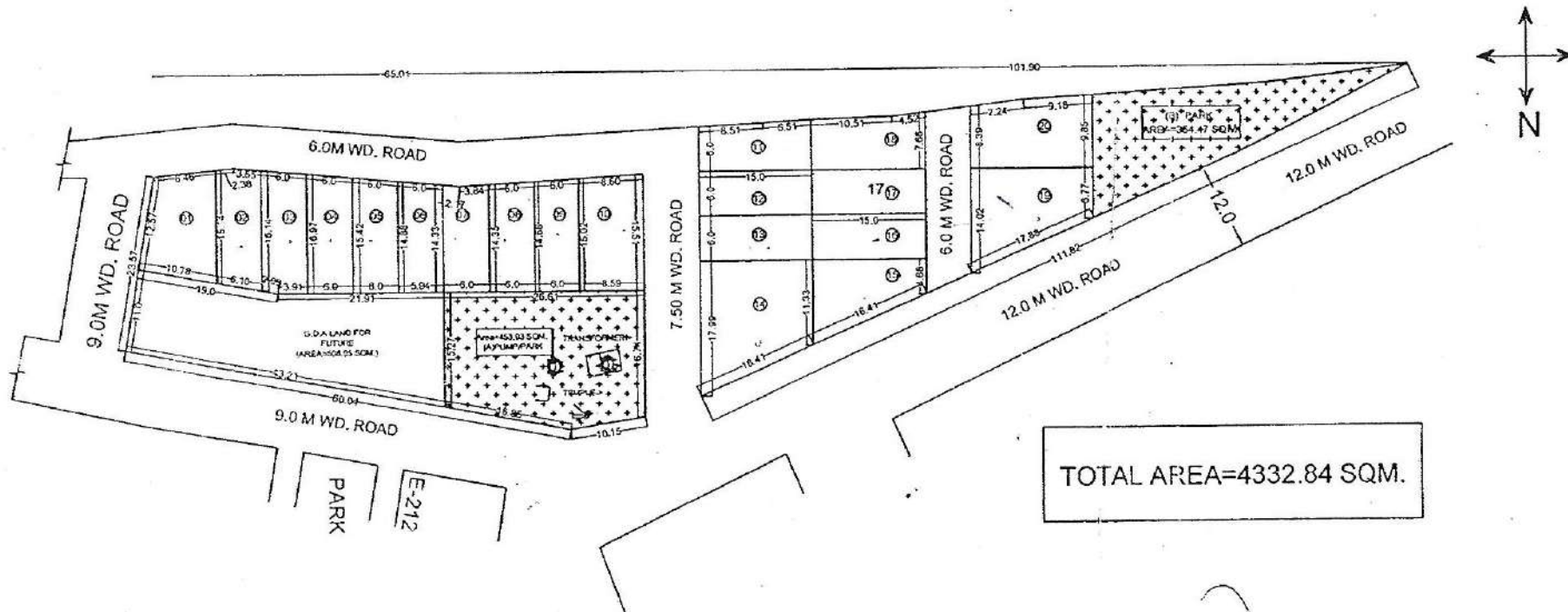

PART . A

S.NO.	PLOT NO.	AREA
(01)	E-01	131.51 SQM.
(02)	E-02	94.62 SQM.
(03)	E-03	97.09 SQM.
(04)	E-04	94.20 SQM.
(05)	E-05	90.91 SQM.
(06)	E-06	87.62 SQM.
(07)	E-07	84.81 SQM.
(08)	E-08	87.09 SQM.
(09)	E-09	89.12 SQM.
(10)	E-10	131.09 SQM.
(11)	E-11	95.94 SQM.
(12)	E-12	90.00 SQM.

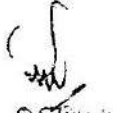
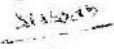
PART . A

S.NO.	PLOT NO.	AREA
((13)	E-13	90.00 SQM.
(14)	E-14	219.77 SQM.
(15)	E-15	120.03 SQM.
(16)	E-16	90.00 SQM.
(17)	E-17	90.00 SQM.
(18)	E-18	106.28 SQM.
(19)	E-19	169.91 SQM.
(20)	E-20	151.00 SQM.
PARK		
(01)	A	453.03 SQM.
(02)	B	354.47 SQM.

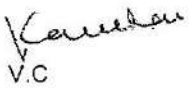

 D/MAN
  AMIN
  O.S.D. (L.A.S.)
  J.E.
  A.E.
  E.E.
  T.P.(R)
  T.P.(K)
  SECY.
  V.C.

PART LAY OUT PLAN FOR NANDGRAM BLOCK - E. GHAZIABAD

91

PART . B

PART . B

S.NO.	PLOT NO.	AREA	S.NO.	PLOT NO.	AREA
(21)	E-21	187.55 SQM.	(34)	E-34	97.74 SQM.
(22)	E-22	90.61 SQM.	(35)	E-35	91.76 SQM.
(23)	E-23	91.87 SQM.	(36)	E-36	84.67 SQM.
(24)	E-24	113.28 SQM.	(37)	E-37	79.48 SQM.
(25)	E-25	99.15 SQM.	(38)	E-38	80.54 SQM.
(26)	E-26	90.05 SQM.	(39)	E-39	87.71 SQM.
(27)	E-27	90.05 SQM.	(40)	E-40	98.74 SQM.
(28)	E-28	133.27 SQM.	(41)	E-41	116.59 SQM.
(29)	E-29	142.53 SQM.	(42)	E-42	108.00 SQM.
(30)	E-30	88.94 SQM.	(43)	E-43	153.78 SQM.
(31)	E-31	93.50 SQM.	(44)	E-44	86.74 SQM.
(32)	E-32	103.93 SQM.	(45)	E-45	86.00 SQM.
(32)	E-32	103.93 SQM.	(46)	E-46	85.07 SQM.
(33)	E-33	98.31 SQM.			
				PARK	
			(01)	A	313.05 SQM.

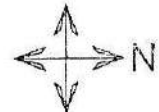
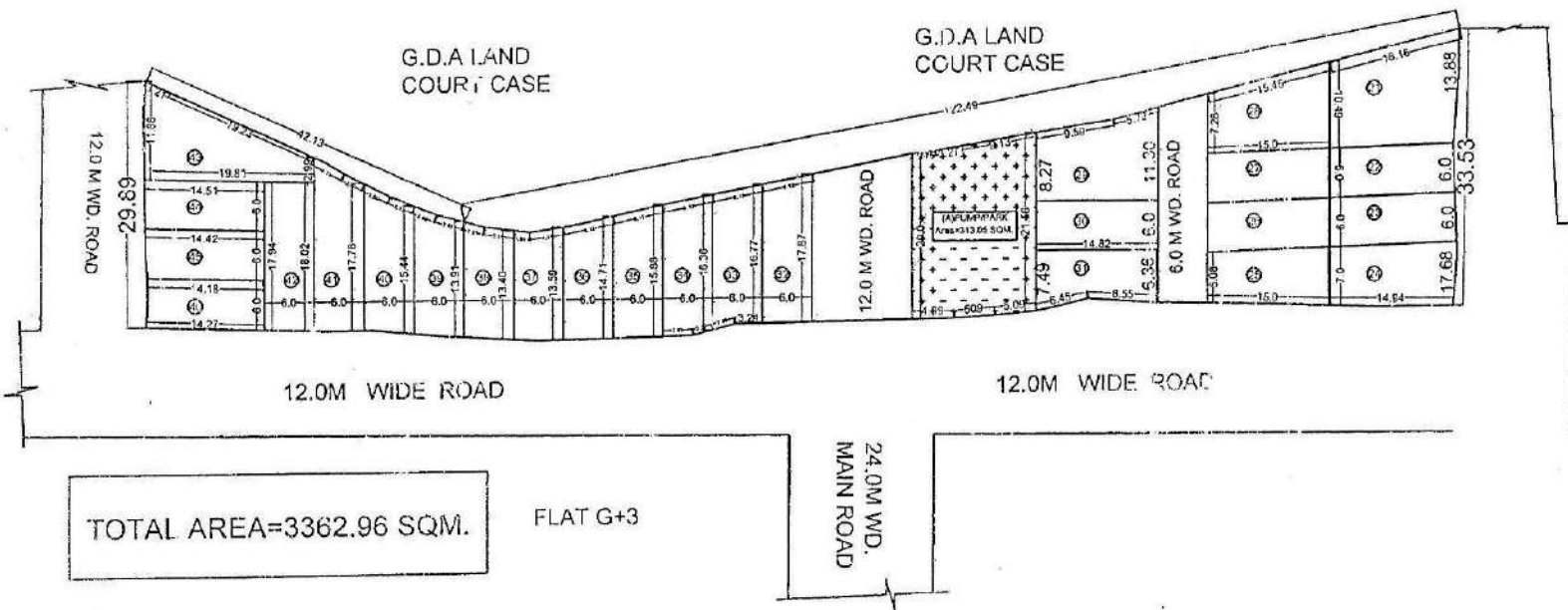

 D/MAN
  AMIN
  OSD(LA)
  J.E
  A.E
  E.E
  T.P(R)
  T.P(K)
 C.A.T.P
 SECY.
 V.C

REVISED SITE PLAN OF SHOPS/RESIDENCE PLOT NO.KA -322 TO KA-324 AT BLOCK KA,
PRATAP VIHAR SECTOR XII G.M.P ,G.D.A. GHAZIABAD.

SHOP/RESI.PLOT NO. KA-322 = 914.31 SQ.M.
 SHOP/RESI.PLOT NO. KA-323 = 912.00 SQ.M.
 SHOP/RESI.PLOT NO. KA-324 = 912.00 SQ.M.

GR.COV. - 60%
 F.A.R. - 1.5

USES:

GR. FLOOR - COMMERCIAL
 FIRST FLOOR - RESIDENTIAL
 SECOND FLOOR - RESIDENTIAL

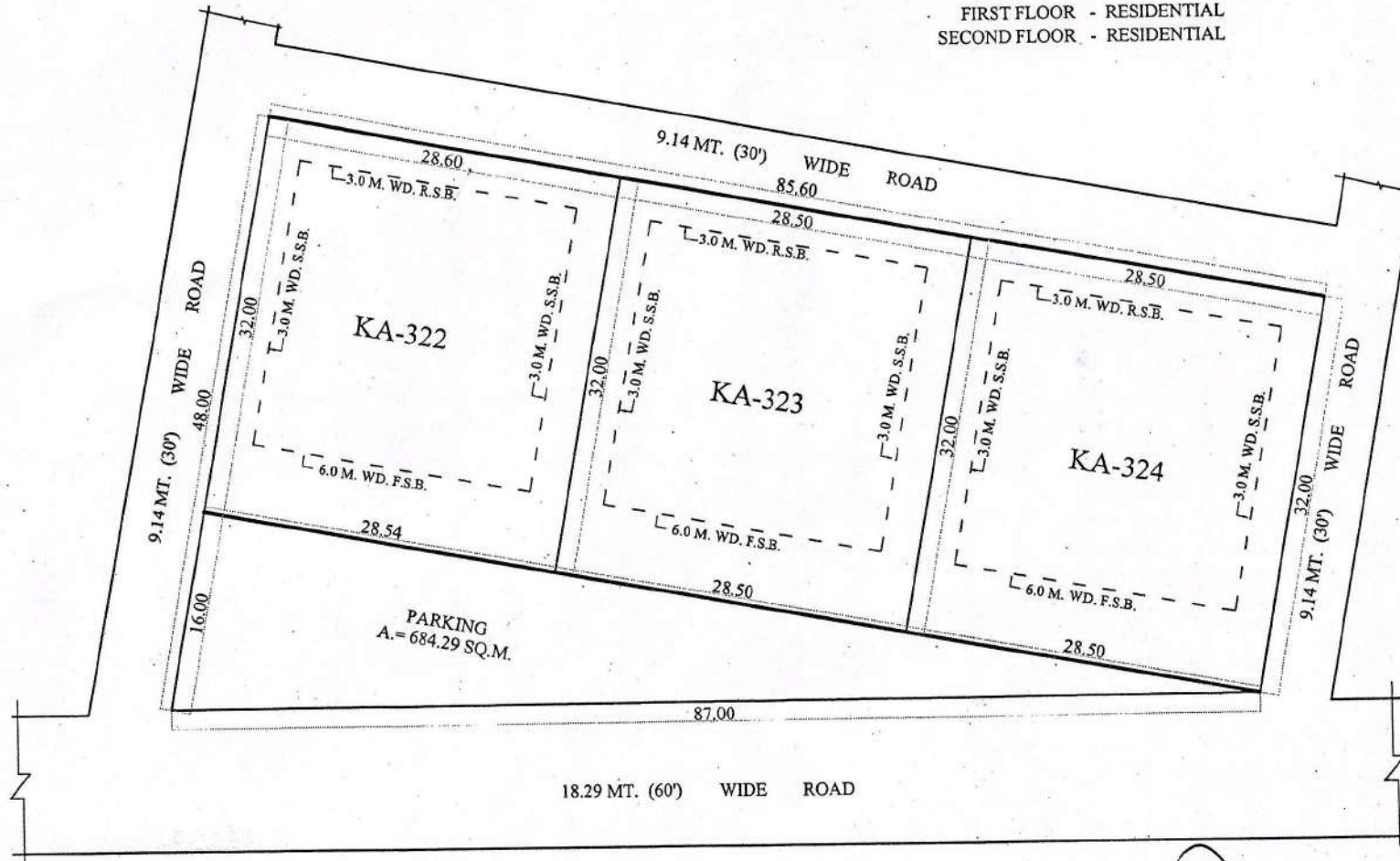
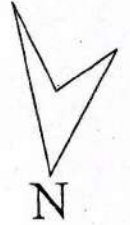

[Signature]
 09/10/2020
 D/MAN

[Signature]
 12/10/2020
 J.E.

[Signature]
 12/10
 A.E.

[Signature]
 12/10/20
 E.E.

[Signature]
 12/10/20
 T.P.(R)

T.P.(K)

C.A.T.P.

[Signature]
 SECRETARY

[Signature]
 VICE CHAIR

REVISED SITE PLAN OF GROUP HOUSING PLOT, NEAR PROPOSED R.O.B. ON 75M M.P. ROAD AT PRATAP VIHAR, GHAZIABAD

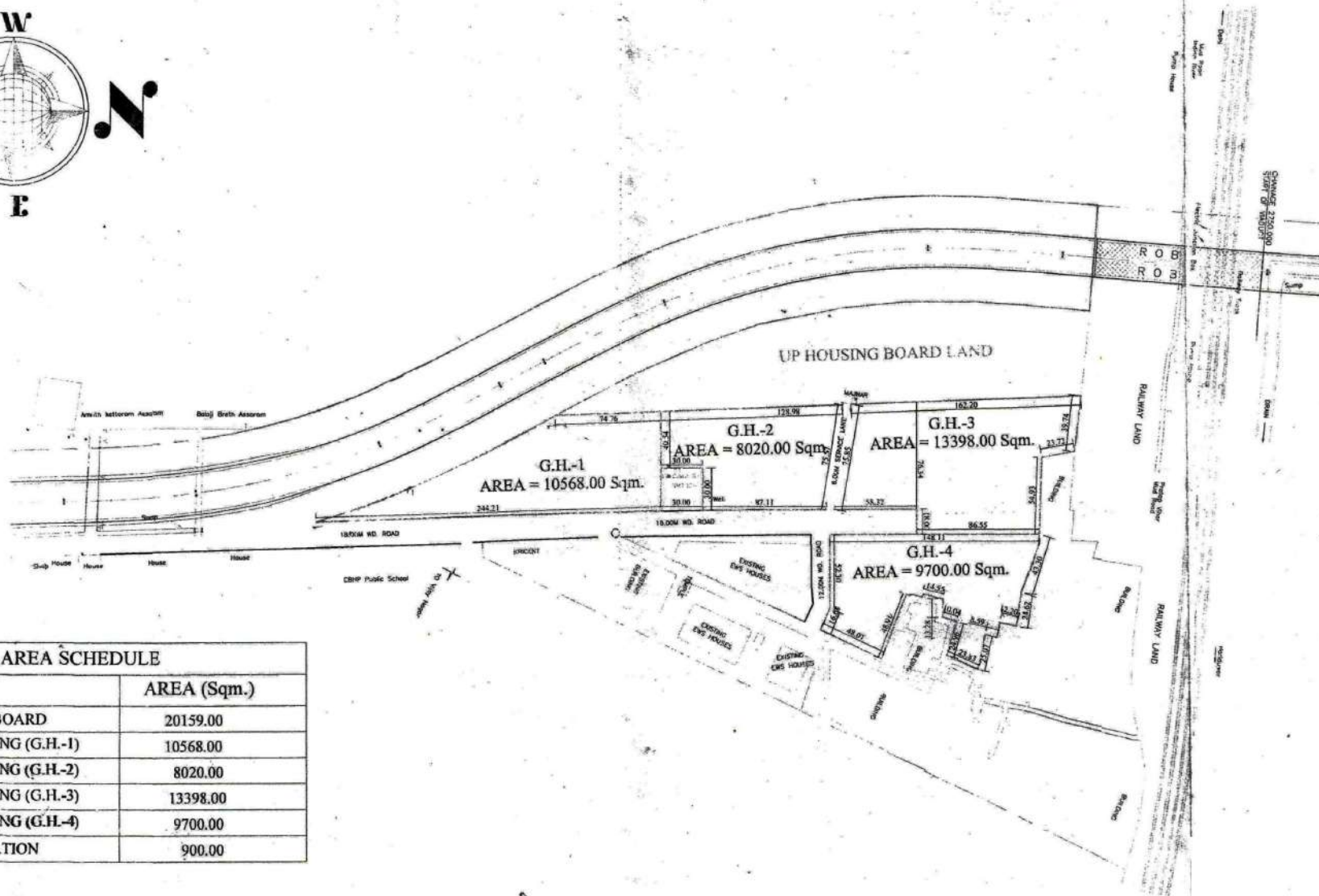
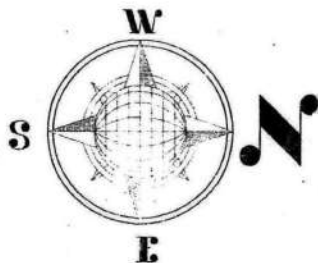

AREA SCHEDULE	
LAND	AREA (Sq.m.)
UP HOUSING BOARD	20159.00
GROUP HOUSING (G.H.-1)	10568.00
GROUP HOUSING (G.H.-2)	8020.00
GROUP HOUSING (G.H.-3)	13398.00
GROUP HOUSING (G.H.-4)	9700.00
ELEC.SUB-STATION	900.00

 D/Man
 AMIN
 J.E.
 A.E.
 E.E.-ZONE 4
 TEH-LA
 T.P.
 C.A.T.P.
 Secy.
 W.C.

SITE PLAN OF KIOSKS PLOT NO..... IN C-BLOCK R.D.C. RAJ-NAGAR GHAZIABAD

TOTAL NOS. OF KIOSKS - 18

15.0 METRE WIDE ROAD

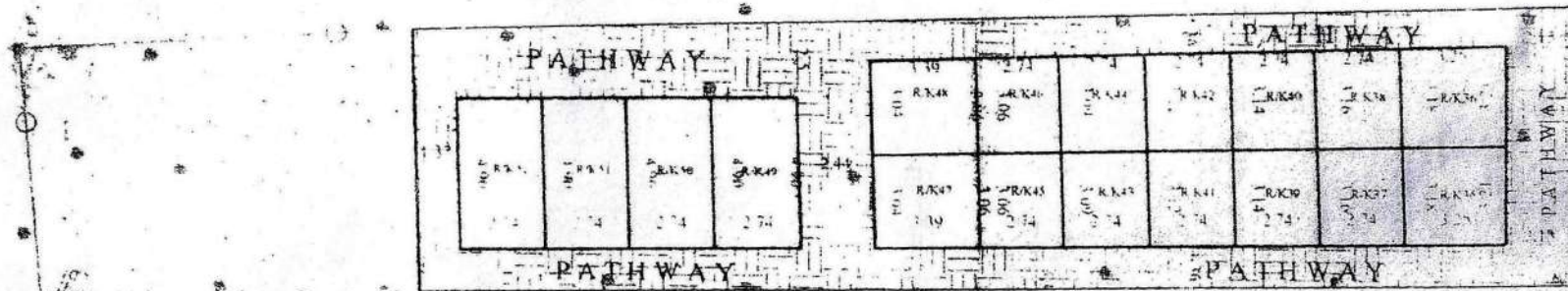

AREA-CHART

- R/K35 & RK36 = 10.38 sq.mt.
- R/K37 & RK38 = 8.68 sq.mt.
- R/K39 & RK40 = 8.63 sq.mt.
- R/K41 & RK42 = 8.57 sq.mt.
- R/K43 & RK44 = 8.50 sq.mt.
- R/K45 & RK46 = 8.43 sq.mt.
- R/K47 & RK48 = 10.34 sq.mt.
- R/K49 TORK52 = 13.42 sq.mt.

12.0 METRE WIDE ROAD

PREPARED BY

COMPARED BY

MEAS.&AREA CAL.(J.E.)

ASIT. ENGR

डा० हरेन्द्र कुमार मिश्र
संयुक्त सचिव
जी० डी० ए०

SITE PLAN FOR KIOSK IN "D" BLOCK PATEL NAGAR, SECTOR - 7 G.M.P. GHAZIABAD

Scale -1:500

AREA OF KIOSK LAND = 116.84 Sqm.

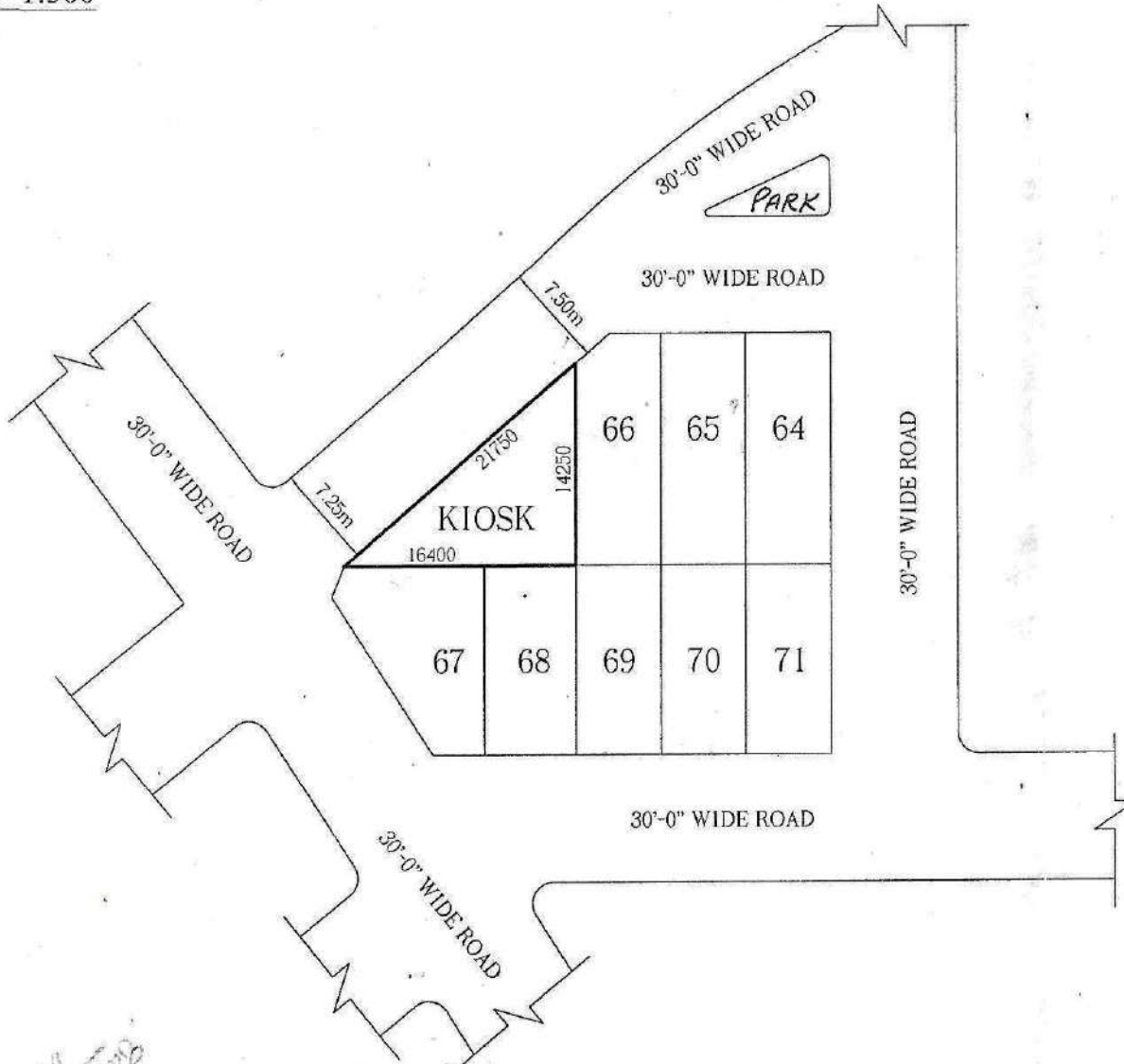

[Signature]
22.4.08

Prepared By.

[Signature]
22.4.08

Compared By.

[Signature]
22.4.08
Measured By.

[Signature]
22.4.08
Asth. Engineer

[Signature]
23/4/08
A.T.P.







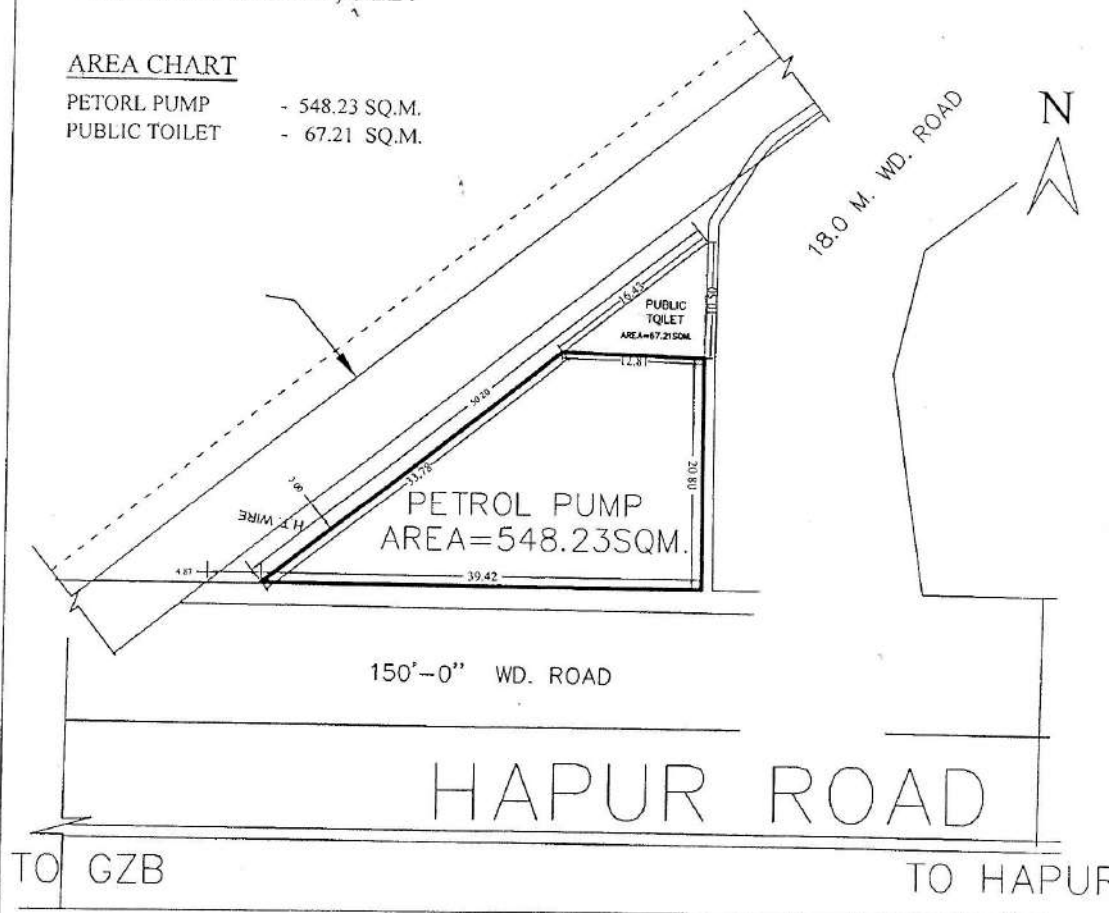

[Signature]
Town Planner.

REVISED SITE PLAN OF PETROL PUMP /PUBLIC TOILET A-BLOCK
GOVINDPURAM ,GZB.

AREA CHART

PETORL PUMP - 548.23 SQ.M.
PUBLIC TOILET - 67.21 SQ.M.



 D/Man
 J.E.
 A.E.
 E.E.
 T.P.
 C.A. (17/10/2016)
 SECRTY.
 V.C.

AT TULSI NIKETAN SCHEME THA IN GHAZIABAD

SCALE : 1 CM = 5 Mts.

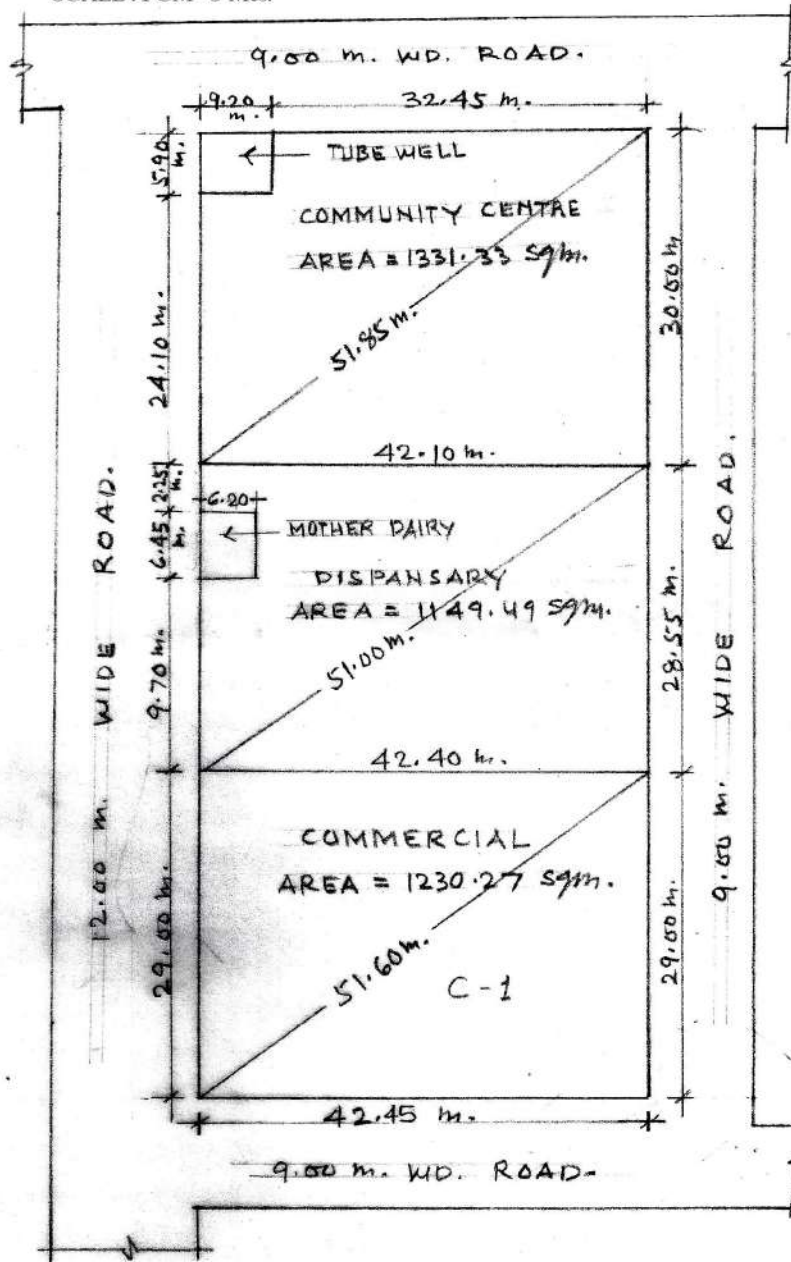

Prepared by: *[Signature]* 10/01/07
 Compared by: *[Signature]* 11/01/07
 Measured by: *[Signature]* 22/01/07
 Assst Engr. Town Planner: *[Signature]* 24/01/07

SITE PLAN FOR CONVENIENT SHOPPING CENTRE AT AT C-BLOCK SWARN JAYANTI PURAM

PRODUCED BY AN AUTODESK EDUCATIONAL PRODUCT

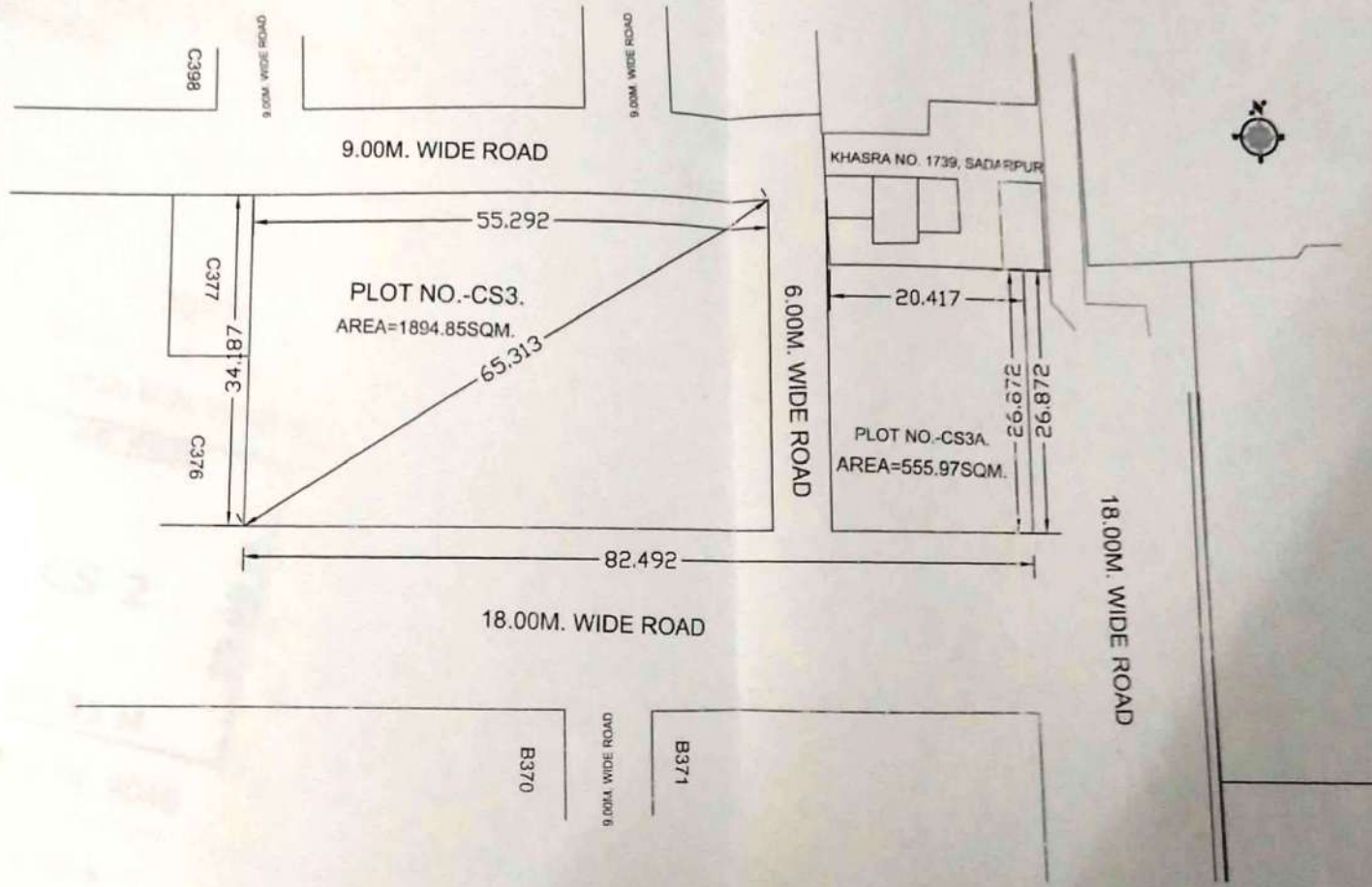

21/05/13.
D./MAN
 J.E.
 21/05/13
A.E.
 EX.EN
 N.T.
 20/7/13
T.P
C.E.
 C.A.T.P
 SECY.

PRODUCED BY AN AUTODESK EDUCATIONAL PRODUCT

Scanned by CamScanner

PROPOSED PART LAYOUT PLAN AT SECTOR III, BEHIND CHAAYA PUBLIC SCHOOL.VAISHALI

(POCKET - NP)

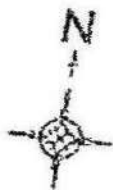

PLOTS SIZE = 16.50 X 8.50 M.
 AREA = 140.25 SQ M.
 NO. OF PLOTS = 18

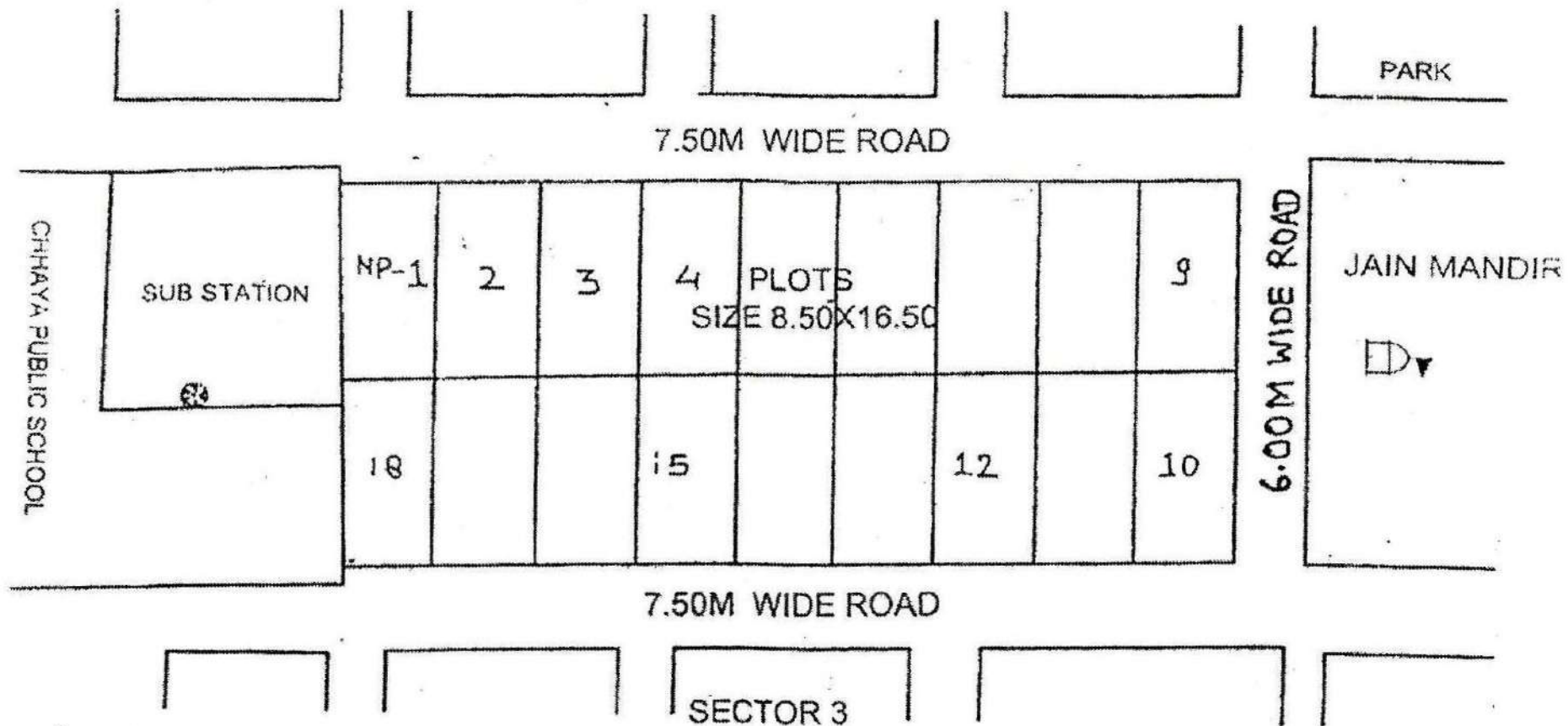

[Signature]
 D/IMAN

[Signature]
 19/10/12
 TOWN PLANNER

[Signature]
 CATP

[Signature]
 SECY.

[Signature]

SITE PLAN OF NURSERY SCHOOL PLOT (NS-1 & NS-2)
AND CRESCH. PLOT AT E BLOCK BRIJVIHAR
SECTOR NO-VIII T.H.A GZB.

AREA CHART=

NS-1=1015.31 SQM ✓

NS-2=882.95 SQM

CRESCH

PLOT= 490.0 SQM

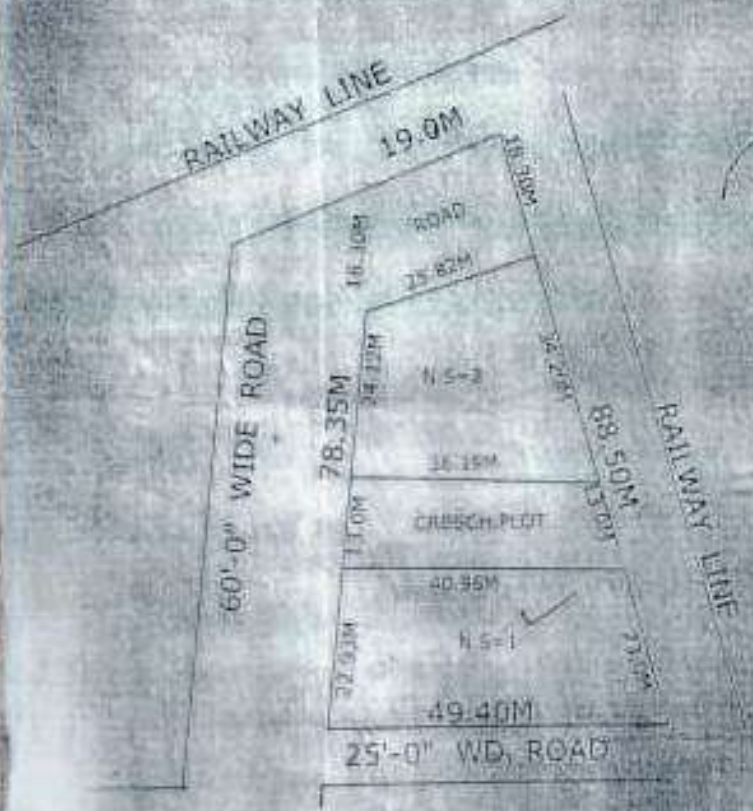
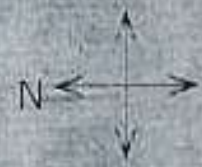

SITE PLAN OF PLOT P/NS AT INDIAN

SCHEME IN POKET 'D' GHAZIABAD

TOTAL AREA

PART .A+B+C=5144.49 SQM

ALL DIMENSION IN METER
NOT TO SCALE

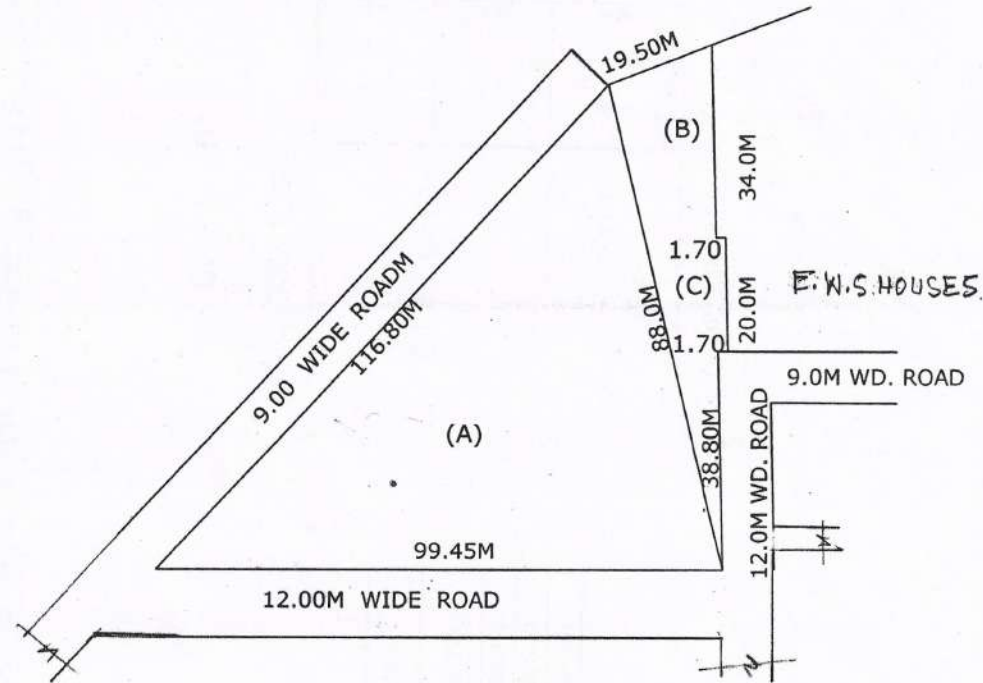
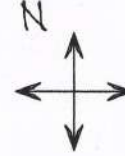

Handwritten signature
31/07/08

PREPARED BY

Handwritten signature
31/08/08

COMPARED BY

sd
(RAKESH TOMER) (V.NATH.)

MEASURED BY

A.E.

Handwritten signature
31/08/08

ATP.

T.P.

REVISED SITE PLAN OF PLOT NOS. 248 TO 254 & P/N SCHOOL AT KAUSHAMBI GZB.

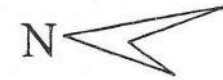
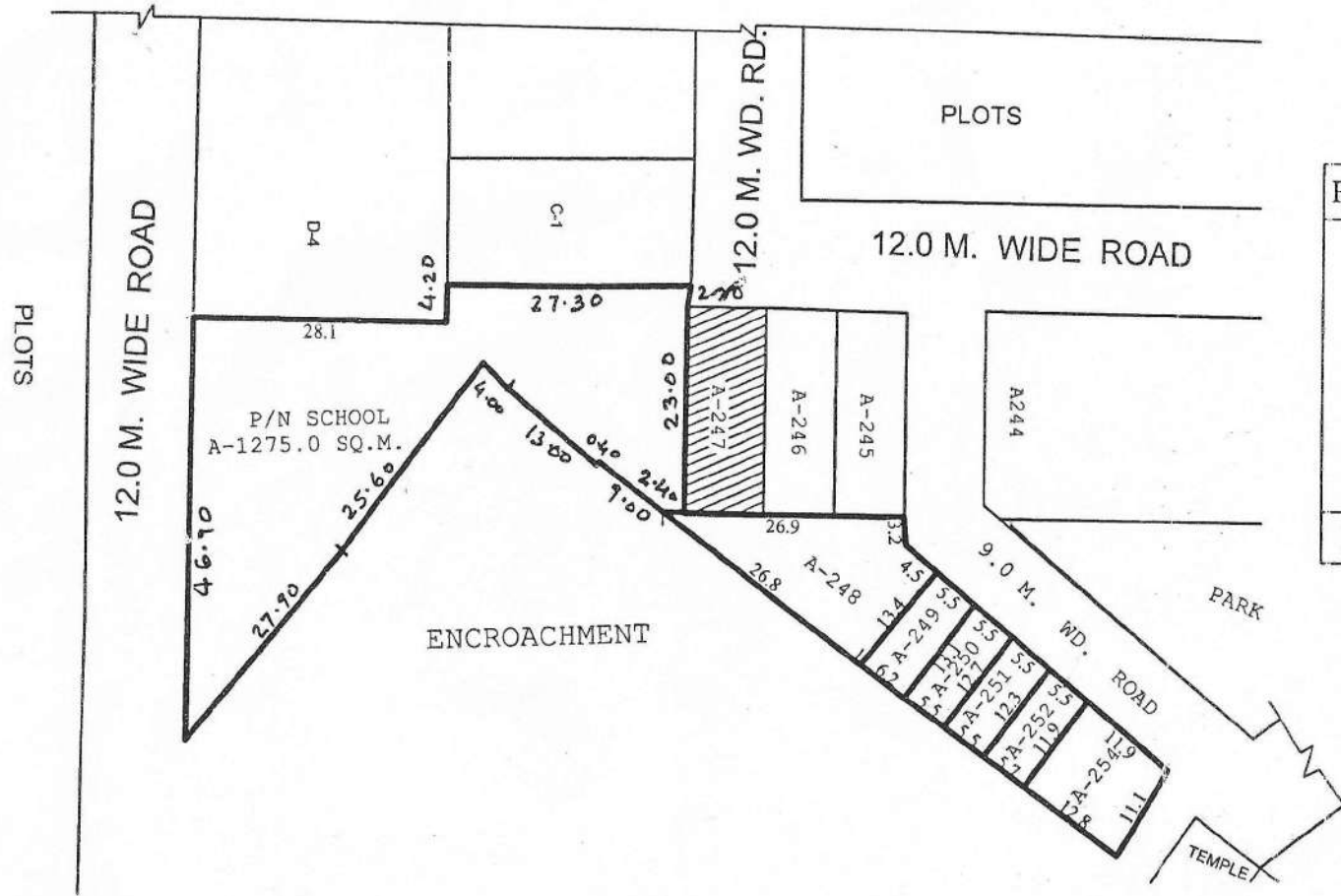

PLOT NO.	AREA (SQ.M.)
A-248	258.00 SQ.M.
A-249	77.05 SQ.M.
A-250	70.58 SQ.M.
A-251	69.28 SQ.M.
A-252	67.60 SQ.M.
A-254	141.10 SQ.M.
P/N SCH.	1275.0 SQ.M.
MISSING PLOT	A-253

4-6-15

Man

[Signature]

AMIN

[Signature]

J.E.

[Signature]

A.E.

[Signature]

E.E.

[Signature]

TEH-LA

[Signature]

T.P.

[Signature]

C.A.T.P.

[Signature]

SECRY.

[Signature]

V.C.

REVISED LAYOUT PLAN OF KOYAL ENCLAVE SCHEME, GHAZIABAD

AREA STATEMENT

TOTAL AREA OF SCHEME	= 417875 SQM
AREA UNDER BUILT UP	= 3745 SQM
AREA UNDER ROAD (WIDENING)	= 15471 SQM
NET SCHEME AREA	= 392659 SQM

AREA UNDER GROUP HOUSING:-

1. GH-1	= 9900 SQM
2. GH-1A	= 7000 SQM
3. GH-2	= 16200 SQM
4. GH-3	= 6000 SQM
5. GH-3A	= 5250 SQM
6. GH-3B	= 5750 SQM
7. GH-4	= 19500 SQM
8. GH-5	= 12000 SQM
9. GH-6	= 12000 SQM
10. GH-7	= 6700 SQM
11. GH-7A	= 6400 SQM
12. GH-7B	= 6700 SQM
13. GH-8	= 6400 SQM
14. GH-9	= 6800 SQM
15. GH-10	= 7100 SQM
16. GH-11	= 4700 SQM
17. GH-12	= 7210 SQM
18. GH-12A	= 2090 SQM
19. GH-13	= 21800 SQM

TOTAL AREA UNDER GROUP HOUSING

TOTAL AREA UNDER COMMERCIAL	= 16700 SQM
TOTAL AREA UNDER FACILITIES (HEALTH, SCHOOL & COMMUNITY FACILITIES)	= 38150 SQM
TOTAL AREA UNDER OPEN PARK/POND	= 58900 SQM
TOTAL AREA UNDER FILLING STATION	= 4550 SQM
AREA UNDER ROADS FOR FUTURE	= 31000 SQM
	= 73859 SQM



PRODUCED BY AN AUTODESK EDUCATIONAL PRODUCT

PROP. SITE PLAN FOR HEALTHCARE HUB AT POCKET-E MADHUBAN BAPUDHAM YOJNA; GZB.
 AREA - 33484.50 SQ.M.

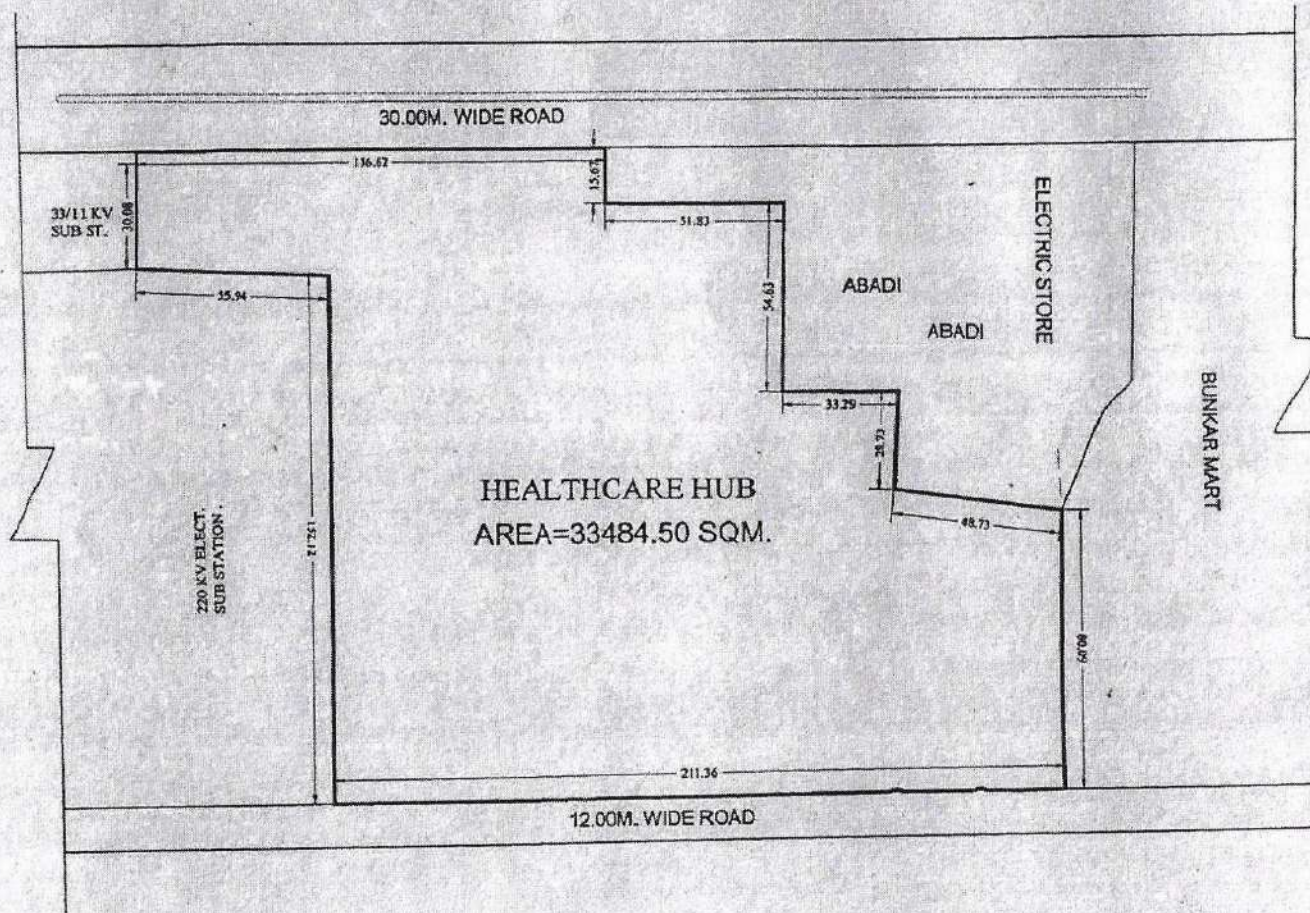

[Signature]
D/Man

[Signature]
AMIN

[Signature]
J.E.

[Signature]
A.E.

[Signature]
A.T.R.

[Signature]
OSD

[Signature]
E.E. T.P.

[Signature]
C.A.T.P.

[Signature]
SECRETARY

[Signature]
VICE CHAIRMAN



MASTER PLAN GREEN

2471550 MT

B

POLICE CHAUK

community centre

primary school

PARK

பொது பள்ளி

Madhubom Babudhorm
Primary School

18.00 METER WIDE ROAD

18.00 METER WIDE ROAD

12.00 METER WIDE ROAD

9.00 METER WIDE ROAD

7.50 METER WIDE ROAD

7.50 METER WIDE ROAD

7.50 METER WIDE ROAD

18.00 METER WIDE ROAD

9.00 METER WIDE ROAD

9.00 METER WIDE ROAD

9.00 METER WIDE ROAD

9.00 METER WIDE ROAD

9.00 METER WIDE ROAD

18.00 METER WIDE ROAD

9.00 METER WIDE ROAD

12.00 METER WIDE ROAD

9.00 METER WIDE ROAD

7.50 METER WIDE ROAD

7.50 METER WIDE ROAD

16.00 METER WIDE ROAD

18.00 METER WIDE ROAD

12.00 METER WIDE ROAD

RAILWAY LINE

45.00 METER WIDE M.P. ROAD

56

57

154 153

126 125

168 141

140 111

83

110

31

82

30

1

86

97

18

15

PARK
MASTER PLAN GREEN
43320SQ. MT.

D

O.H.T.

O.H.T.

PARK
45029 SQ. MT.

PARK
4378.MT

PARK
6584 SQ.MT

P.H.

12.00x25.00
300.00 SQ. MT.

12.00x25.00
300.00 SQ. MT.

12.00x25.00
300.00 SQ. MT.

PRIMARY
SCHOOL
2000 SQ.M

G.H.
11191 SQ.MT.

G.H.
13280 SQ.MT.

G.H.
10593 SQ.MT.

G.H.
10513 SQ.MT.

G.H.
14672 SQ.MT.

G.H.
19361 SQ.MT.

G.H.
18185 SQ.MT.

PARK
8561 SQM

PARK
6100 SQM

U.G.R.

*Madhusam Babudham
School Plot*

100.00 METER WIDE ROAD

WIDE M.P. ROAD

18.00 METER WIDE ROAD

12.00 METER WIDE ROAD

18.00 METER WIDE ROAD

12.00 METER WIDE ROAD

12.00 METER WIDE ROAD

18.00 METER WIDE ROAD

12.00 METER WIDE ROAD

12.00 METER WIDE ROAD

12.00 METER WIDE ROAD

18.00 METER WIDE ROAD

9.00 METER WIDE ROAD

9.00 METER WIDE ROAD

9.00 METER WIDE ROAD

9.00 METER WIDE ROAD

9.00 METER WIDE ROAD

9.00 METER WIDE ROAD

9.00 METER WIDE ROAD

539 540

529 550

12.00x25.00
300.00 SQ. MT.

551 584

601 636

600 637

585 652

682 653

780 727

683 726

3609

807 832

739 768

688 667

845 846

750x500

750x500

2000 SQ.M

2000 SQ.M

11191 SQ.MT.

13280 SQ.MT.

10593 SQ.MT.

10513 SQ.MT.

14672 SQ.MT.

19361 SQ.MT.

18185 SQ.MT.

8561 SQM

6100 SQM

U.G.R.

Madhusam Babudham School Plot

100.00 METER WIDE ROAD

WIDE M.P. ROAD

18.00 METER WIDE ROAD

9.00 METER WIDE ROAD

9.00 METER WIDE ROAD

9.00 METER WIDE ROAD

9.00 METER WIDE ROAD

9.00 METER WIDE ROAD

OPOSED SITE PLAN FOR HIGH SCHOOL PLOT AT POCKET-E (PART) MADHUBAN BAPUDHAM YOJNA; GZB.

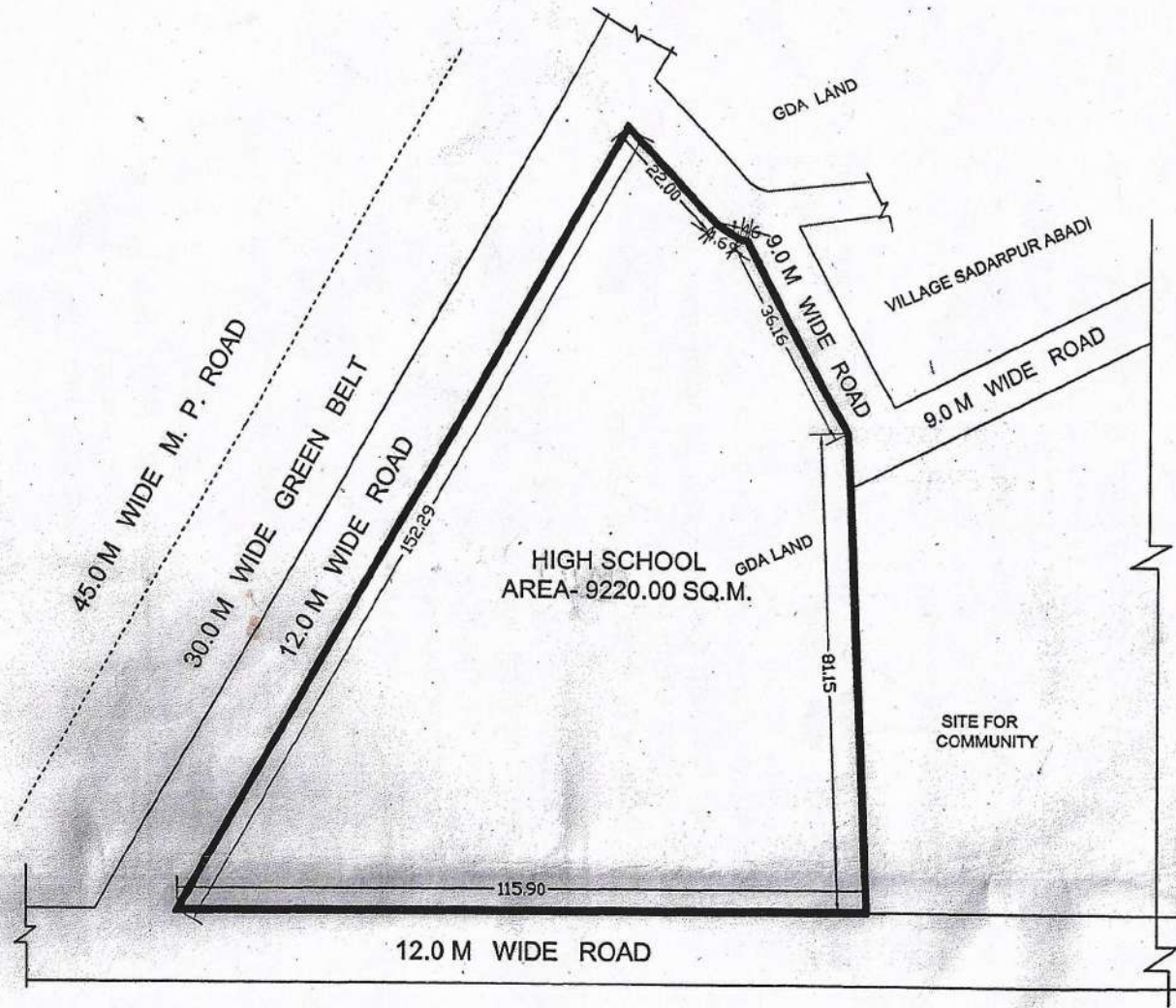

SWARNAYANTIPURAM YOJNA

Man AMIN J.E. A.E. E.E. OSD (LA) T.P. (R) T.P. (R) SECRETARY VICE CHAIRMAN

15/07/2018